

KURIN CONDIMENT CART (SINGLE BIN)

Designed by Giordano Caldarini

boreka
by KIAN



Product Description

Frame	:	Solid ash wood
Countertop	:	Solid surface
Detailing	:	Stainless steel in hairline finish
Carcass & Shelving	:	Ash veneer
Glides	:	Plastic PC
P/S	:	Including 1pc PE bin (3.7kg capacity for each bin)

Material Finishes

Wood Stain (Indoor)



ASH-Natural

ASH-Cigar

ASH-Classic

ASH-Matt Black

ASH-Mocha

Stainless Steel Hairline



Hairline Stainless Steel

Hairline Bronze
M24

Hairline Gold
M23

Solid Surface

Check with Sales Consultant

Patent Registration:



0.61 m3
1 PC/CCTN

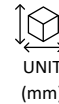

Height : 1010
Wide : 900
Depth : 556

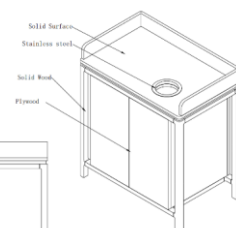
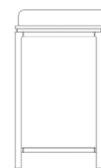
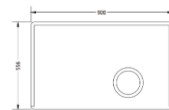

UNIT (mm)